

|             |                          |
|-------------|--------------------------|
| Universe    | Professional             |
| Type        | Lighting                 |
| Category    | New Headlamp Accessories |
| Subcategory | New Headlamp Accessories |



## SLOT ADAPT

Plate for mounting a headlamp on a Petzl VERTEX or STRATO helmet, maintaining the ability to tilt the headlamp.



The SLOT ADAPT plate allows you to mount a compatible headlamp on a VERTEX or STRATO helmet.

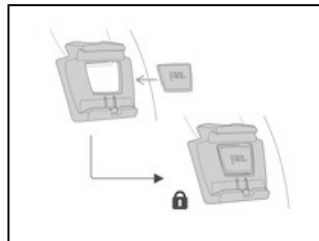

The adhesive locking plate allows you to permanently install the plate on the helmet.

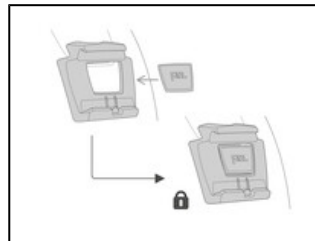

Le verrou adhésif permet d'installer de manière définitive la platine sur le casque.

---

**Short Description** Plate for mounting a headlamp on a Petzl helmet

---

**Selling Points**

- Easily mount a headlamp on a Petzl helmet (or other helmet with a slot system) while maintaining the ability to tilt the headlamp
- Possible to permanently install with a detachable adhesive locking plate
- Compatible with the ARIA range headlamps

---

**Specification**

- Weight: 11g

---

**Specifications by reference**

|                     |                 |
|---------------------|-----------------|
| <b>Reference(s)</b> | <b>E073BA00</b> |
| Made in             | MY              |
| Guarantee           | 3 years         |
| Inner Pack Count    | 1               |
| Quantity Per Box    | 210             |
| EAN                 | 3342540840645   |

---

**Related product(s)**

- ARIA 2R
- ARIA 1R
- ARIA 1
- ARIA 2
- ARIA 2 RGB
- ARIA 1 RGB
- VERTEX®
- VERTEX® VENT
- STRATO®
- STRATO® VENT